

# Temperature Sensor

Model: WN34

## Contents

1. Getting Started .....	3
1.1 Parts List .....	3
2. Overview .....	4
2.1 Features .....	6
3. Setup Guide .....	9
3.1 Installing battery .....	9
4. Sensor Placement .....	11
5. Wi-Fi Configuration with gateway .....	16
5.1 Pair with Gateway .....	17
5.2 Wi-Fi Connection for the Gateway .....	18
6. View Online Data with WS View Plus .....	19
7. Set Email Alerts .....	22
8. Specification .....	23
9. Warranty Information .....	24



- \* Please scan the QR code to read English manual and keep it for future reference
- \* Bitte scannen Sie den QR-Code zudeutsche Anleitung lesen und aufbewahren fürZukunftsbezug
- \* Si prega di scansionare il codice QR perleggi il manuale italiano e conservalo perReferenza futura

## Instruction manuals

<https://www.ecowitt.com/support/download/105>



MADE IN CHINA



AC WORKS CONSULTING Srl  
Via VIlfredo Pareto 125,47521  
Casena(FC),ITALY



HUA TENG LIMITED  
3 Glass Street, Hanley, Stoke On Trent,  
ST1 2ET United Kingdom

# **1. Getting Started**

## **1.1 Parts List**

One Temperature Sensor

One Mounting bracket for sensor

One Hose clamp for mounting to pole

One Hexagon M12 screw for mounting

One Screw ST D3.2\*M2.0\*6 for mounting

One User Manual

## 2. Overview

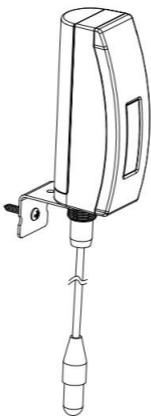

Figure 1: Temperature Sensor (cabled version)



Figure 2: Temperature Sensor (probe version)

Note: This temperature sensor has two versions: a probe version (WN34S) and a cabled version (WN34L) as your selection. The probe sensor is mainly used to test the soil temperature, while the cabled version is mainly used to test water temperature.

The two versions will be recognized as the same sensor type by the software. If you purchased both, they will share the eight channels together and the total supported quantity of the two sensors could not exceed eight for one receiver.

## **2.1 Features**

### **Temperature Sensor**

- Measures temperature with a 3m (10ft)

cabled sensor for the cabled version or a 30cm (11.81inch) stainless steel probe sensor for the probe version.

- Extended wireless range up to 300 feet (100 meters) in open areas.
- Transmits readings every 77 seconds.
- IP65 waterproof.
- LCD display for current reading.

### **When paired with a GW1000/GW1100 Wi-Fi Gateway:**

- View temperature reading on the Live Data page of the WS View Plus app (requires that the gateway and your phone are using the same Wi-Fi network).
- Up to 8 channels supported. Channel names can be edited on the app.
- Battery level information displayed on the

## WS View Plus App.

### **When paired with a Weather Station Console (HP2551/HP3500/HP3501):**

- View temperature data in real-time on the Display.
- Up to 8 channels supported. Channel names can be edited on the console.

### **When uploaded to Ecowitt Weather Server:**

- View current temperature data, history records and graph on the website.
- Receive email alerts from the server.
- Remote monitoring with smart phone, laptop, or computer by visiting the website.



## 3. Setup Guide

### 3.1 Installing battery

1. Remove the battery door on the back of the transmitter by removing the screw, as shown in Figure 2:

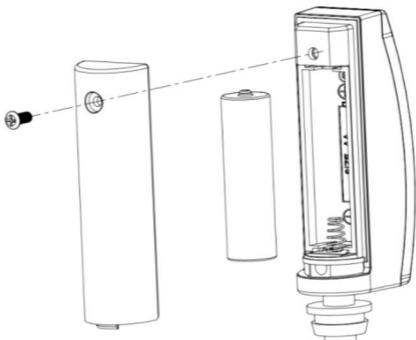

Figure 2: Battery installation

2. Insert one 1.5V AA battery (be aware of polarity: flat side of the battery goes to the spring side of the battery compartment).

The temperature reading will display on the LCD screen immediately and will normally update every 77 seconds (the sensor transmission update period).

Note: If there is no reading on the screen, make sure the battery is inserted the correct way or a proper reset happens. Make sure the battery is inserted correctly. Do not install the battery backward.

4. Close the battery door by installing the screw.

## 4. Sensor Placement

To mount the unit on a wall or wooden beam:

- Use a screw (Screw ST D3.2\*M2.0\*6) to fix the bracket on the wall, and then insert the probe through the hole of the bracket, as shown on figure 3-1:



(cabled version)

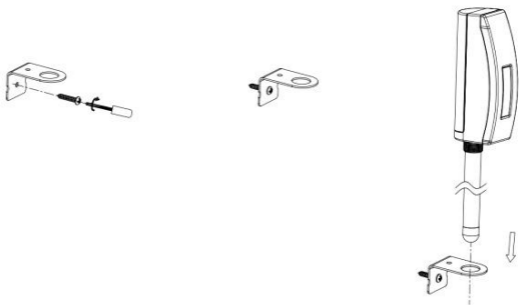

(probe version)

Figure 3-1: Sensor mounting

Fix the sensor to the bracket with the Hexagon M12 nut and tighten the screw as shown on figure 3-2: (hand turn the nut until firm, and then use a wrench to turn  $1/3 \sim 1/2$  turn and no more. Do not over tighten.)



(cabled version)

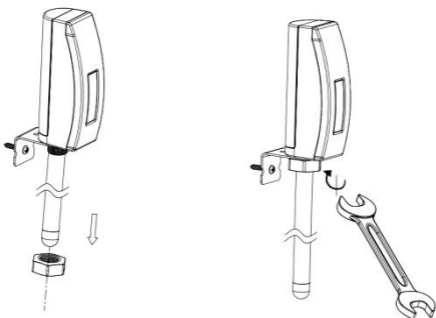

(probe version)

Figure 3-2: Sensor mounting

To mount the unit to a pole (not included) with the included hose clamp:

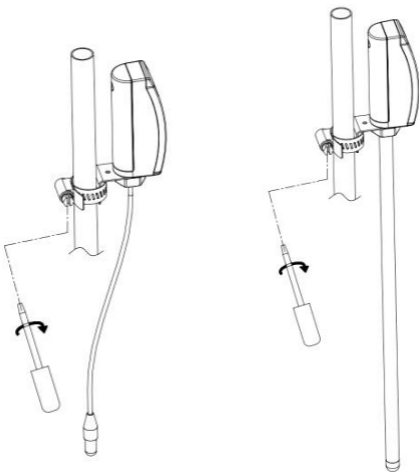

Figure 4: Sensor mounting to pole (left for the cabled version, right for the probe version)

Note:

When installing the soil temperature sensor in the soil, please do not push the probe into the soil by holding the main unit body instead of the probe itself. The unit is fragile between the probe and main body attachment and can only withstand a maximum force of 5kg.

Please don't insert the sensor into corrosive liquids or hard rock to avoid any damage.

## **5. Wi-Fi Configuration with gateway**

To view the sensor data on your mobile application and receive email alerts on our weather server, you need to pair this device with our GW1000/GW1100 Wi-Fi Gateway or HP2551/HP3500/HP3501 Weather Station (each sold separately).



## 5.1 Pair with Gateway

If the GW1000/GW1100 has been in operation, and you have never had any WN34 sensor setup before, just power up the sensor and GW1000/GW1100 will pick the sensor data automatically.

Note: The gateway can support a maximum of 8 WN34 temperature sensors. Each new sensor will be recognized as a new channel according to the Power-on sequence. You may attach a label to the channel on each sensor for distinction. The channel name can be edited both on the app and ecowitt.net (The edited name on the app will not sync to the ecowitt.net website, and it should be edited on your device setup page on ecowitt.net separately).

If you want to use a new WN34 sensor to replace the old one (already configured on certain channel), please try the following:

1. Open the Sensor ID page on the WS View Plus app, and find your old sensor ID.
2. Power off the old sensor and power on the new sensor.
3. Click Re-register on the Sensor ID page.

Then the new sensor will be learned and the old sensor will be erased.

## **5.2 Wi-Fi Connection for the Gateway**

For this part, please refer to the manual of the GW1000/GW1100 Wi-Fi gateway.

If you have any questions, please contact the customer service at [support@ecowitt.com](mailto:support@ecowitt.com) or [support.eu@ecowitt.net](mailto:support.eu@ecowitt.net) (EU/UK).

## **6. View Online Data with WS View Plus**

When the Wi-Fi configuration is done (to tell the gateway to be hooked to your Wi-Fi network), your sensor data as well as the sensor battery voltage information will be displayed on WS View Plus App at the Live Data page.

Device List		Live Data		More	
GW1000B-WIFI38B4					
Indoor Temperature		Indoor Humidity			
26.5 °C		65 %			
Absolute Pressure		Relative Pressure			
1000.1 hPa		1015.7 hPa			
/ CH1 Temp		24.3 °C		[Battery Icon]	
GW1000B_V1.6.5					

Back		Live Data		More	
GW1000B-WIFI38B4 V1.6.5					
Indoor Temperature		Indoor Humidity			
26.5 °C		65 %			
Absolute Pressure		Relative Pressure			
1000.3 hPa		1015.9 hPa			
/ CH1 Temperature		24.3 °C		[Battery Icon]	
Firmware Version					
GW1000B_V1.6.5					

Note: It requires your phone and the gateway must be in the same network when viewing your sensor live data on the WS View Plus app. Live data refers to current data received by the gateway and is not stored on WS

View Plus app. However data is always pushed and saved on [www.ecowitt.net](http://www.ecowitt.net) cloud (under your registered account, and it can always be accessed via your browser.)

Detailed operation instructions can be found in the GW1000/GW1100 manual.

For any questions, please feel free to contact our customer service at [support@ecowitt.com](mailto:support@ecowitt.com) or [support.eu@ecowitt.net](mailto:support.eu@ecowitt.net) (EU/UK).

## 7. Set Email Alerts

Once your device is added successfully on the Ecowitt Weather server, you may set alerts for the sensor on the website to get email notifications.

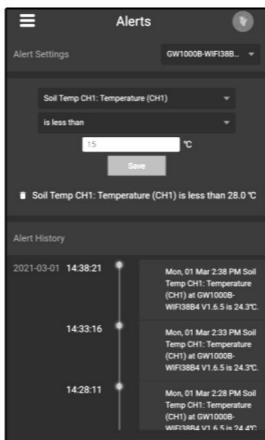

The screenshot shows the 'Alerts' configuration page for a sensor. At the top, there is a hamburger menu icon, the title 'Alerts', and a dropdown arrow. Below this, the 'Alert Settings' section is active for the device 'GW1000B-WIFI38B...'. The configuration includes a dropdown menu for 'Soil Temp CH1: Temperature (CH1)', a comparison operator 'is less than', and a numerical input field set to '15' with a '°C' unit. A 'Save' button is positioned below the input field. A confirmation message below the settings reads: 'Soil Temp CH1: Temperature (CH1) is less than 28.0 °C'. The 'Alert History' section at the bottom features a vertical timeline with three entries for March 1st, 2021, at 14:28:11, 14:33:16, and 14:38:21. Each entry includes a timestamp and a detailed log message: 'Mon, 01 Mar 2:38 PM Soil Temp CH1: Temperature (CH1) at GW1000B-WIFI38B4 V1.6.5 is 24.3°C'.

## **8.Specification**

Power: 1x1.5V AA battery (not included)

Sensor type: Epoxy Sealed Thermistor of NTC

Frequency: 433 / 868 / 915 MHz depending on location (North American: 915 MHz; Europe: 868MHz; Other areas: 433MHz)

Wireless transmitting range: 100M (300feet)

Sensor reporting interval: 77 seconds

Sensing temperature: -40~60 °C(40~140 °F)

Cable sensor length: 3m (10ft)

Probe sensor length: 30cm (11.81inch)

Battery life: 12 months minimum

Waterproof level: IP65

## **9. Warranty Information**

We disclaim any responsibility for any technical error or printing error, or the consequences thereof.

All trademarks and patents are recognized.

We provide a 1-year limited warranty on this product against manufacturing defects, or defects in materials and workmanship.

This limited warranty begins on the original date of purchase, is valid only on products purchased, and is only applicable to the original purchaser of this product. To receive warranty service, the purchaser must contact us for problem determination and service procedures.



This limited warranty covers only actual defects within the product itself and does not cover the cost of installation or removal from a fixed installation, normal set-up or adjustments, or claims based on misrepresentation by the seller, or performance variations resulting from installation-related circumstances.